

**HP STORM DUAL WALL FABRICATED REDUCERS**  
**30" x 12" - 36" x 24" DIAMETER (IB BELLBELL)**

PART #	PIPE SIZE	A	B	C	JOINT
3074AN65BP	30 x 12 in (750 x 300 mm)	25.1 in (638 mm)	18.6 in (472 mm)	6.5 in (165 mm)	WT
3075AN65BP	30 x 15 in (750 x 375 mm)	26.4 in (669 mm)	18.6 in (472 mm)	7.8 in (197 mm)	WT
3076AN65BP	30 x 18 in (750 x 450mm)	27.5 in (698 mm)	18.6 in (472 mm)	8.9 in (226 mm)	WT
3077AN65BP	30 x 24 in (750 x 600 mm)	25.6 in (650 mm)	18.6 in (472 mm)	7.0 in (178 mm)	WT
3674AN65BP	36 x 12 in (900 x 300 mm)	26.0 in (661 mm)	19.5 in (496 mm)	6.5 in (165 mm)	WT
3675AN65BP	36 x 15 in (900 x 375 mm)	27.3 in (693 mm)	19.5 in (496 mm)	7.8 in (197 mm)	WT
3676AN65BP	36 x 18 in (900 x 450 mm)	28.4 in (721 mm)	19.5 in (496 mm)	8.9 in (226 mm)	WT
3677AN65BP	36 x 24 in (900 x 600 mm)	26.5 in (674 mm)	19.5 in (496 mm)	7.0 in (178 mm)	WT

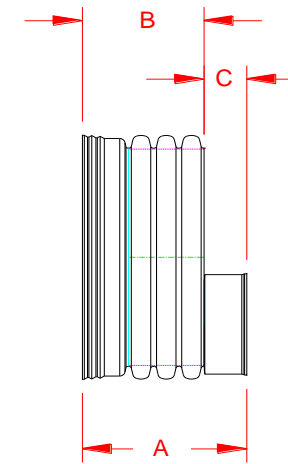

WT (INCLUDES 1 GASKETS)

NOTE: ALL FITTINGS DIMENSIONS ARE FOR REFERENCE ONLY

© 2021 Advanced Drainage Systems, Inc.

	DRAWING #:	HP 12250	
	DRAWN BY:	TJR	8/6/2010
	APPROVED BY:		
	REVISIONS:	TJR	5/13/2014