

ROAD & HIGHWAY

32 __ AGS __ X
32 __ AGR __ X

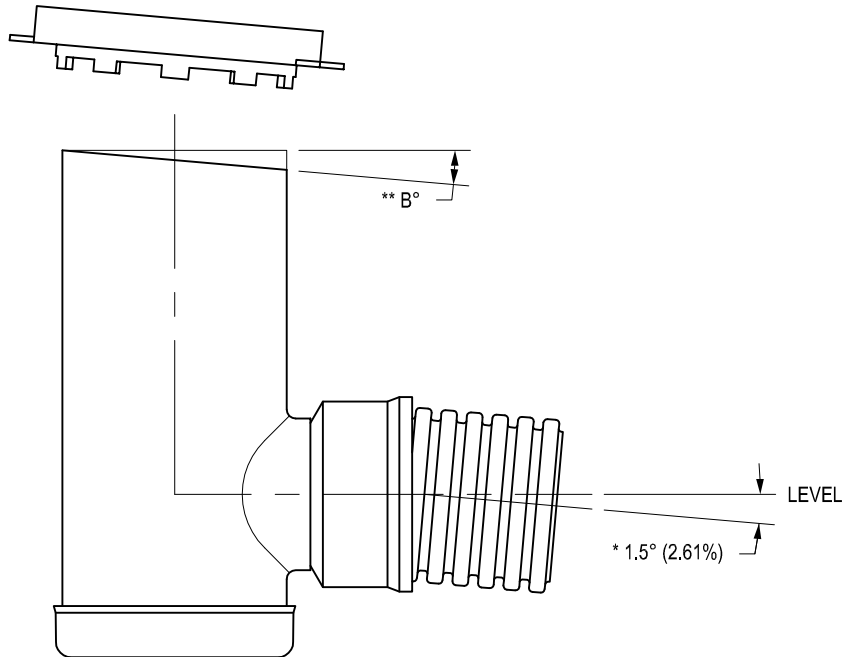

STRUCTURE SIZE	B°	B%
12"	3.15	5.50
15"	3.15	5.50
18"	3.01	5.25
24"	3.15	5.50
30"	2.86	5.00

CURB INLET

30 __ AGS __ X
30 __ AGR __ X

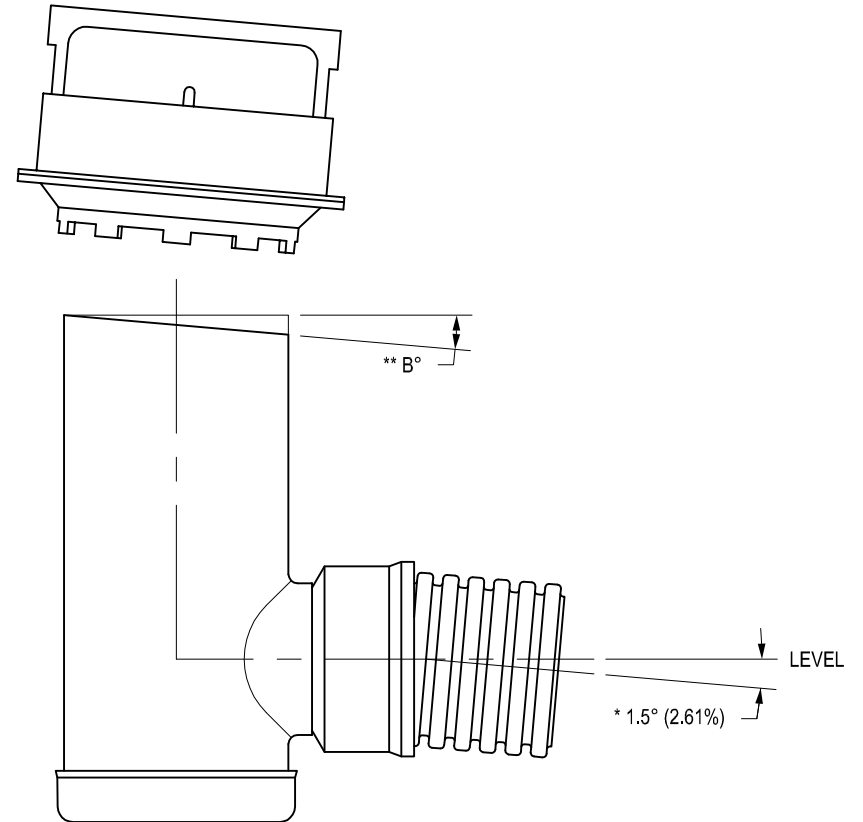

* MAXIMUM DEFLECTION FOR 4" - 30" ADS N-12/HANCOR DUAL WALL CORRUGATED HDPE PIPE IN ANY DIRECTION

** MAXIMUM FIELD GRADE TRIM ADJUSTMENT

THIS PRINT DISCLOSES SUBJECT MATTER IN WHICH NYLOPLAST HAS PROPRIETARY RIGHTS. THE RECEIPT OR POSSESSION OF THIS PRINT DOES NOT CONFER, TRANSFER, OR LICENSE THE USE OF THE DESIGN OR TECHNICAL INFORMATION SHOWN HEREIN REPRODUCTION OF THIS PRINT OR ANY INFORMATION CONTAINED HEREIN, OR MANUFACTURE OF ANY ARTICLE HEREFROM, FOR THE DISCLOSURE TO OTHERS IS FORBIDDEN, EXCEPT BY SPECIFIC WRITTEN PERMISSION FROM NYLOPLAST.

©2013 NYLOPLAST

DRAWN BY	EBC	MATERIAL
DATE	02-05-09	
REVISED BY	CCA	PROJECT NO./NAME
DATE	09-04-13	
DWG SIZE	A	SCALE 1:16 SHEET 1 OF 1



3130 VERONA AVE
BUFORD, GA 30518
PHN (770) 932-2443
FAX (770) 932-2490
www.nyloplast-us.com

TITLE	
12 IN - 30 IN ROAD & HIGHWAY & CURB INLET FIELD ADJUSTMENTS	
DWG NO.	7001-110-346 REV C