

# Envirohood® Structure

The Nyloplast® EnviroHood® is an innovative stormwater management device attached to the inside of a catch basin or manhole designed to prevent the outflow of floating debris and oil. The need for cleaner stormwater has caused municipal leaders to demand forward-thinking solutions to improve their overall water quality. The EnviroHood offers lower installed costs and less intrusive installations than competitive devices.

## Engineered for Optimal Performance

The innovative design incorporates the same proven corrugation technology used on ADS N-12® pipe products. This delivers maximum strength to weight ratio and ensures the structure is capable of supporting the hydraulic forces of a rainfall event.

## Features & Benefits

- Molded from High Density Polyethylene (HDPE) for lightweight and sturdy design
- Corrugated design eliminates flat surfaces and provides increased structural capacity
- Effective low-cost solution for storm water treatment
- Easy to clean
- Highly corrosion-resistant for long service life

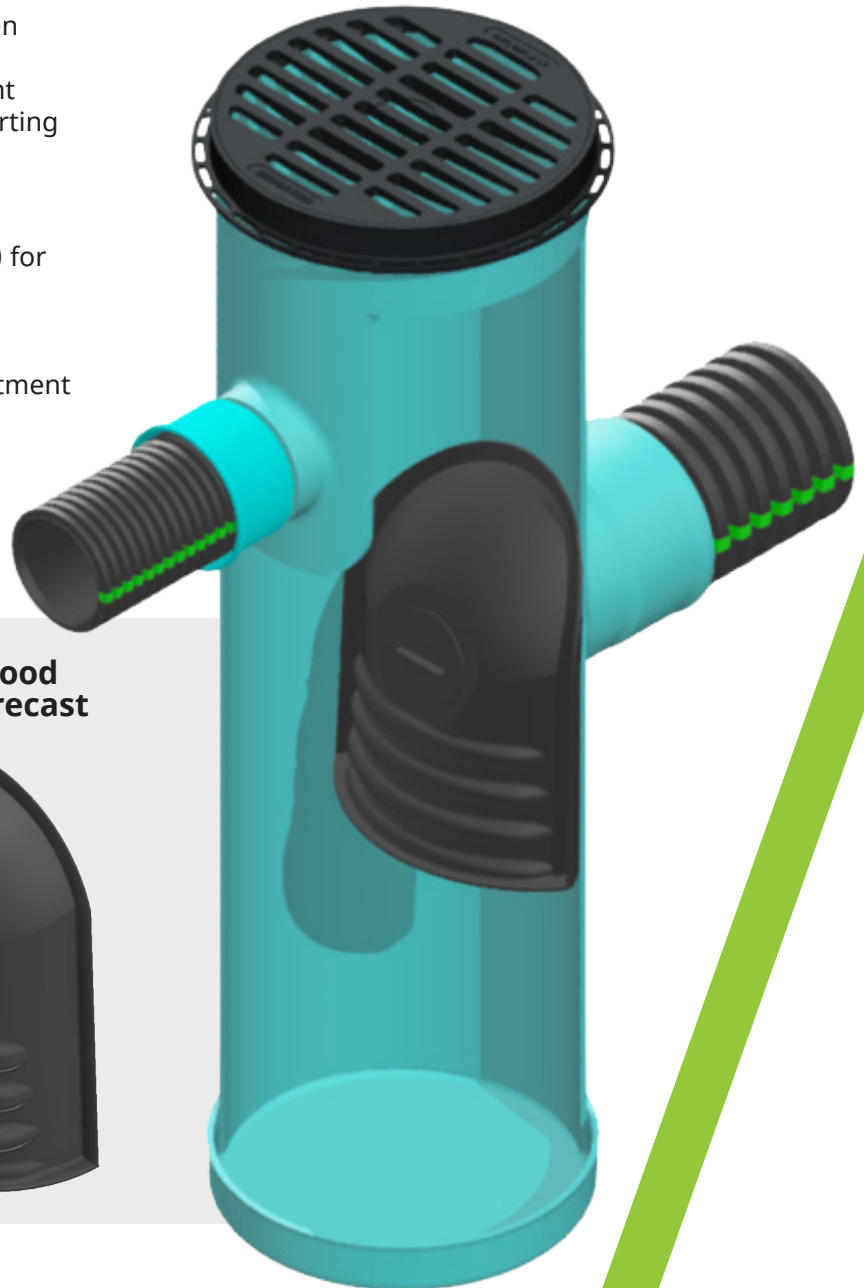

**Envirohood  
for Nyloplast**



**Envirohood  
for Flat Precast**



# Nyloplast Envirohood Specification

## Scope

This specification describes the EnviroHood for use in stormwater conveyance systems.

## Requirements

- All hoods are constructed of polyethylene.
- The size and position of the hood are determined by the outlet pipe size.
- Installation hardware and instructions are provided with each Envirohood.
- Installation shall be in accordance with Nyloplast installation procedures and those issues by local building/construction regulations.

## Typical Installation

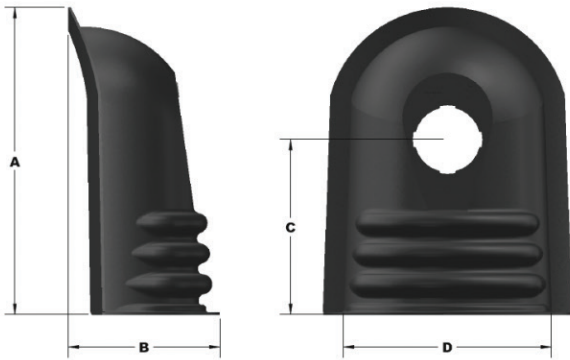
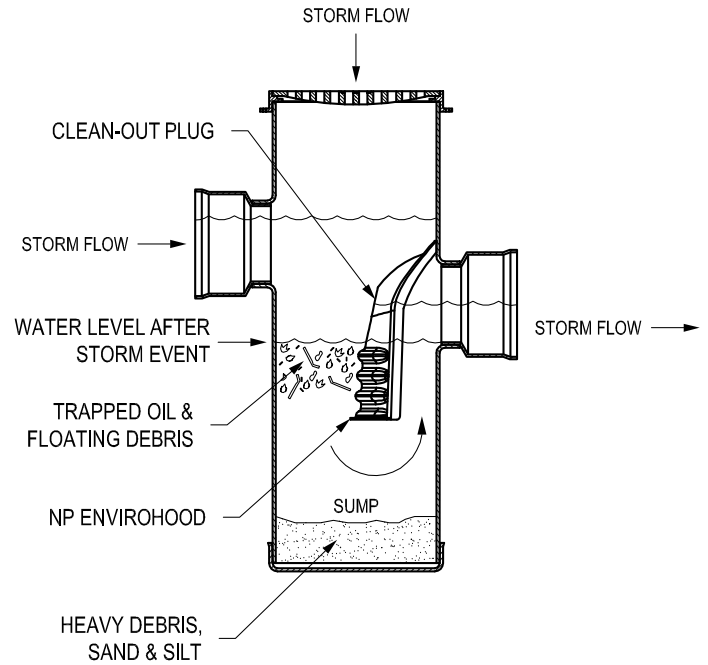

| Structure Type                        | Outlet Covered     | Part Number* | General Dimensions in. (mm) |              |              |              |
|---------------------------------------|--------------------|--------------|-----------------------------|--------------|--------------|--------------|
|                                       |                    |              | A                           | B            | C            | D            |
| 48" (1200 mm) Round Concrete          | up to 18" (450 mm) | 5818AGR      | 30.2 (767.1)                | 14.9 (378.5) | 17.2 (436.9) | 20.5 (520.7) |
| 48"-54" (1200-1350 mm) Round Concrete | up to 24" (600 mm) | 5824AGR      | 41.7 (1059.2)               | 18.0 (457.2) | 26.9 (683.3) | 26.9 (683.3) |
| 54"-60" (1350-1500 mm) Round Concrete | up to 30" (750 mm) | 5830AGR      | 48.7 (1237.0)               | 20.5 (520.7) | 30.5 (774.7) | 33.1 (840.7) |
| Flat Concrete                         | up to 18" (450 mm) | 5818AGF      | 30.2 (767.1)                | 11.8 (299.7) | 17.2 (436.9) | 20.4 (518.2) |
| Flat Concrete                         | up to 24" (600 mm) | 5824AGF      | 41.8 (1061.7)               | 15.3 (388.6) | 26.9 (683.3) | 27.0 (685.8) |
| Flat Concrete                         | up to 30" (750 mm) | 5830AGF      | 48.8 (1239.5)               | 18.3 (464.8) | 30.5 (774.7) | 34.0 (863.6) |
| 18" (450 mm) Nyloplast*               | up to 12" (300 mm) | 5818AG0412   | 19.4 (492.8)                | 9.8 (248.9)  | 12.3 (312.4) | 13.8 (350.5) |
| 24" (600 mm) Nyloplast*               | up to 15" (400 mm) | 5824AG0415   | 26.5 (673.1)                | 12.8 (325.1) | 14.5 (368.3) | 20.0 (508.0) |
| 30" (750 mm) Nyloplast*               | up to 18" (450 mm) | 5830AG0418   | 32.8 (833.1)                | 15.4 (391.2) | 18.7 (475.0) | 26.0 (660.4) |

\* Sold with Nyloplast Basins

Contact your local sales representative for more information.



adspipe.com

800-821-6710