

SANITITE® HP TRENCH INSTALLATION DETAIL

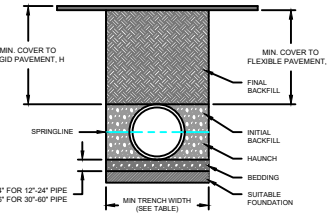

TABLE 1. RECOMMENDED MINIMUM TRENCH WIDTHS

PIPE DIAM	MIN. TRENCH WIDTH	PIPE DIAM	MIN. TRENCH WIDTH
12\"/>			

TABLE 2. MINIMUM RECOMMENDED COVER BASED ON VEHICLE LOADING CONDITIONS

PIPE DIAM	SURFACE LOAD (MINIMUM CONDITION)	
	CLASS I	CLASS II
12\"/>		

TABLE 3. MAXIMUM COVER FOR ADS SANITITE® HP PIPE, R (in)

PIPE DIAM	CLASS I		CLASS II	
	COMPACTED	95%	90%	95%
12\"/>				

- NOTES:**
- ALL PIPE SYSTEMS SHALL BE INSTALLED IN ACCORDANCE WITH ASTM D2321, "STANDARD PRACTICE FOR UNDERGROUND INSTALLATION OF THERMOPLASTIC PIPE FOR SEWERS AND OTHER GRAVITY FLOW APPLICATIONS", LATEST EDITION.
 - MEASURES SHOULD BE TAKEN TO PREVENT MIGRATION OF NATIVE FINES INTO BACKFILL MATERIAL WHEN REQUIRED.
 - FOUNDATION:** WHERE THE TRENCH BOTTOM IS UNSTABLE, THE CONTRACTOR SHALL EXCAVATE TO A DEPTH REQUIRED BY THE ENGINEER AND REPLACE WITH SUITABLE MATERIAL AS SPECIFIED BY THE ENGINEER. AS AN ALTERNATIVE AND AT THE DISCRETION OF THE DESIGN ENGINEER, THE TRENCH BOTTOM MAY BE STABILIZED USING A GEOTEXTILE MATERIAL.
 - BACKFILL:** SUITABLE MATERIAL SHALL BE CLASS I OR II. THE CONTRACTOR SHALL PROVIDE DOCUMENTATION FOR MATERIAL SPECIFICATION TO ENGINEER. COMPACTION SHALL BE SPECIFIED BY THE ENGINEER IN ACCORDANCE WITH TABLE 3 FOR THE APPLICABLE FILL HEIGHTS LISTED. UNLESS OTHERWISE NOTED BY THE ENGINEER, MINIMUM BEDDING THICKNESS SHALL BE 4\"/>

ALTERNATE PRECAST MANHOLE CONNECTION WITH SANITITE® HP PIPE

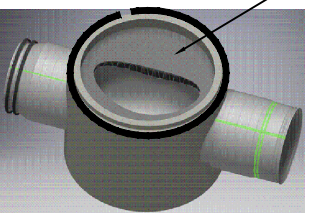

- NOTES:**
- AFTER PIPE IS INSERTED THROUGH MANHOLE, POUR CONCRETE AROUND PIPE IN MANHOLE.
 - CUT SECTION FROM TOP OF PIPE AND REMOVE IN FIELD FOR PIPE ACCESS.
 - FILL ALL OPEN CORRUGATION VOIDS WITH NON-SHRINK GROUT, ENSURING GROUT FILLS THE VOID SPACE ALL THE WAY AROUND CIRCUMFERENCE.
 - STRUCTURE DIAMETER & WALL THICKNESS BY ENGINEER.
 - REFER TO ALOK® RECOMMENDATION FOR PROPER GASKET & MANDREL SIZING.
 - PIPE TO BE INSERTED INTO STRUCTURE ABOVE GRADE AND LOWERED IN THE TRENCH AS ONE UNIT.

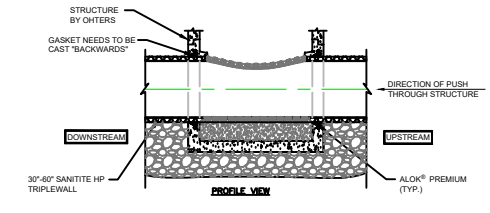

ACCESS MH DETAIL WITH SANITITE® HP PIPE

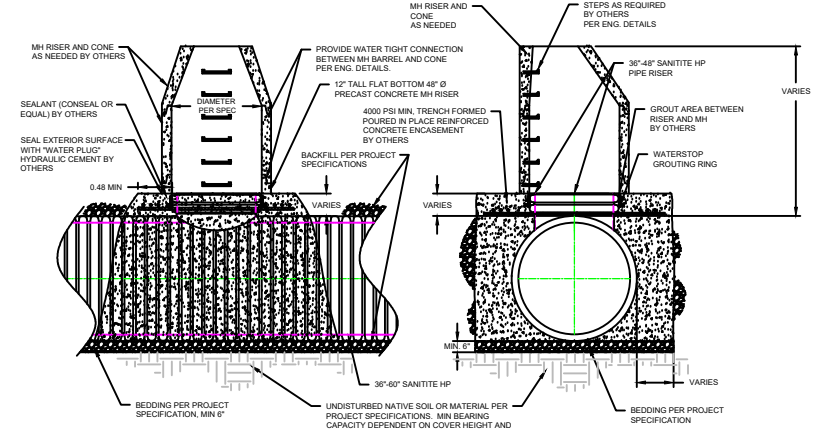

- NOTES:**
- REFERENCES TO "DESIGN ENGINEER" OR "ENG DETAILS" REFER TO THE ENGINEER OF RECORD AND PROJECT PLANS FOR THE SPECIFIC SANITARY SEWER PROJECT.
 - STEEL REINFORCING AND CONCRETE ENCASSEMBMENT SHALL BE DESIGNED BY OTHERS (ENGINEER OF RECORD, CONTRACT ENGINEER, ETC.) FOR THE SPECIFIC PROJECT AND SITE CONDITIONS.
 - SANITITE® HP PIPE RISER (30\", 42\", OR 48\") WILL BE SHIPPED 12\"/>

STD-101F

STD-205G

COMPRESSION (CAST-IN) RESILIENT STRUCTURE CONNECTION 12\"/>

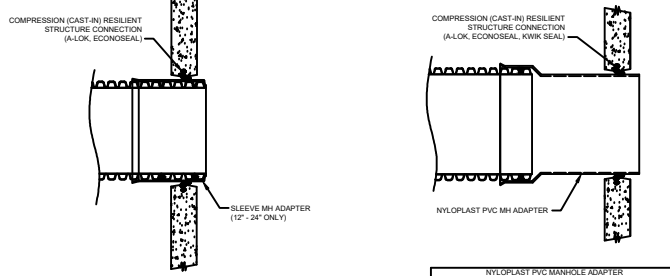

TABLE 1. SANITITE® HP SLEEVE MANHOLE ADAPTER

PIPE SIZE	ADS PRODUCT CODES	ALOK® PREMIUM	PRESS SEAL® SYSTEMS
12\"/>			

- NOTES:**
- PERFORMANCE HIGHLY DEPENDENT ON INSTALLATION. CONTRACTOR MUST ENSURE MANHOLE GASKET IS UNIFORMLY SEATED AROUND STRUCTURE ADAPTER. EXTRA PRECAUTIONS MUST BE TAKEN TO PREVENT DIFFERENTIAL SETTLEMENT BETWEEN THE PIPE AND MANHOLE.
 - SEE STANDARD DETAIL STD-201 AND TECHNICAL NOTE 5:04 CONNECTIONS TO MANHOLES AND STRUCTURES FOR INSTALLATION RECOMMENDATIONS.
 - NYLOPLAST PVC ADAPTER OD EQUIVALENT TO SDR 35

STD-205A

COMPRESSION (CAST-IN) RESILIENT STRUCTURE CONNECTION 30\"/>

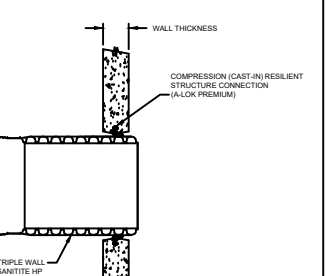

TABLE 1. SANITITE® HP SLEEVE MANHOLE ADAPTER

PIPE SIZE	ALOK® PREMIUM CONNECTOR **	MIN. MH DIAMETER
30\"/>		

- NOTES:**
- PERFORMANCE HIGHLY DEPENDENT ON INSTALLATION. CONTRACTOR MUST ENSURE MANHOLE GASKET IS UNIFORMLY SEATED AROUND PIPE. EXTRA PRECAUTIONS MUST BE TAKEN TO PREVENT DIFFERENTIAL SETTLEMENT BETWEEN THE PIPE AND MANHOLE.
 - SEE STANDARD DETAIL STD-201 AND TECHNICAL NOTE 5:04 CONNECTIONS TO MANHOLES AND STRUCTURES FOR INSTALLATION RECOMMENDATIONS.

STD-205B

12\"/>

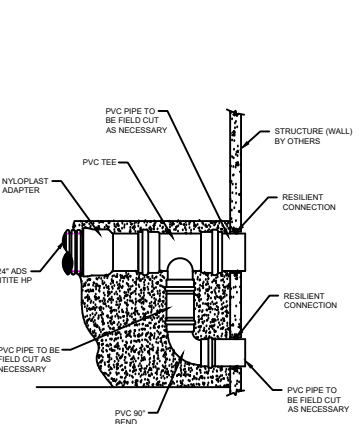

STD-208

30\"/>

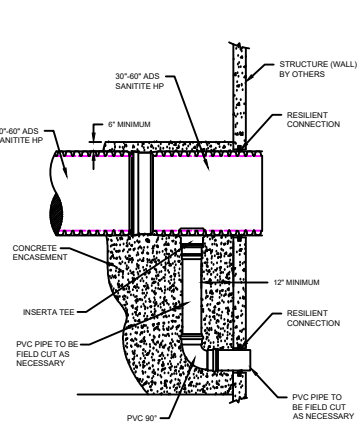

STD-209

INSERTA TEE® INSTALLATION

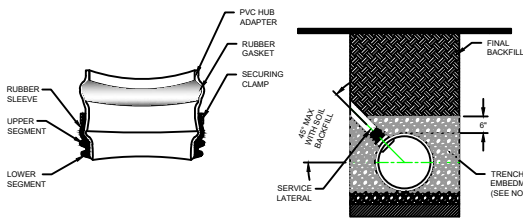

- NOTES:**
- ALL PIPE SYSTEMS SHALL BE INSTALLED IN ACCORDANCE WITH ASTM D2321, "STANDARD PRACTICE FOR UNDERGROUND INSTALLATION OF THERMOPLASTIC PIPE FOR SEWERS AND OTHER GRAVITY FLOW APPLICATIONS", LATEST EDITION. REFERENCE ADS STD DETAIL STD-101 FOR TRENCH CONSTRUCTION RECOMMENDATIONS.
 - MEASURES SHOULD BE TAKEN TO PREVENT MIGRATION OF NATIVE FINES INTO BACKFILL MATERIAL WHEN REQUIRED.
 - THE INSERTA TEE CONNECTION SHOULD NOT BE PLACED AT AN ANGLE EXCEEDING 45° FROM THE SPRINGLINE. GREATER ANGLES ARE SUBJECT TO DESIGN ENGINEER APPROVAL AND MAY REQUIRE ALTERNATE BACKFILL.
 - FOUNDATION:** WHERE THE TRENCH BOTTOM IS UNSTABLE, THE CONTRACTOR SHALL EXCAVATE TO A DEPTH REQUIRED BY THE ENGINEER AND REPLACE WITH SUITABLE MATERIAL AS SPECIFIED BY THE ENGINEER. AS AN ALTERNATIVE AND AT THE DISCRETION OF THE DESIGN ENGINEER, THE TRENCH BOTTOM MAY BE STABILIZED USING A GEOTEXTILE MATERIAL.
 - BEDDING:** SUITABLE MATERIAL SHALL BE CLASS I OR II. THE CONTRACTOR SHALL PROVIDE DOCUMENTATION FOR MATERIAL SPECIFICATION TO ENGINEER. UNLESS OTHERWISE NOTED BY THE ENGINEER, MINIMUM BEDDING THICKNESS SHALL BE 4\"/>

BOOTED (CORED OR CAST HOLE) RESILIENT STRUCTURE CONNECTION 12\"/>

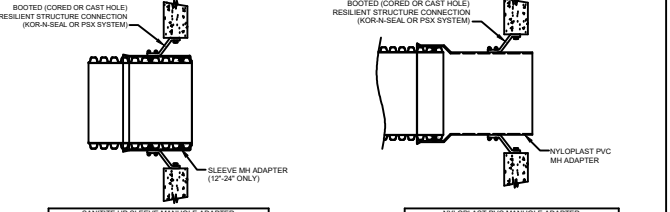

TABLE 1. SANITITE® HP SLEEVE MANHOLE ADAPTER

PIPE SIZE	ADS ADAPTER PRODUCT CODES		TRELLBORG PRESS SEAL SYSTEMS
	PKX DIRECT DRIVE	PKX DIRECT DRIVE	
12\"/>			

- NOTES:**
- PERFORMANCE HIGHLY DEPENDENT ON INSTALLATION. CONTRACTOR MUST ENSURE MANHOLE GASKET IS UNIFORMLY SEATED AROUND STRUCTURE ADAPTER. EXTRA PRECAUTIONS MUST BE TAKEN TO PREVENT DIFFERENTIAL SETTLEMENT BETWEEN THE PIPE AND MANHOLE.
 - SEE STANDARD DETAIL STD-201 AND TECHNICAL NOTE 5:04 CONNECTIONS TO MANHOLES AND STRUCTURES FOR INSTALLATION RECOMMENDATIONS.
 - NYLOPLAST PVC ADAPTER OD EQUIVALENT TO SDR 35

STD-205D

BOOTED (CAST-IN) RESILIENT STRUCTURE CONNECTION 12\"/>

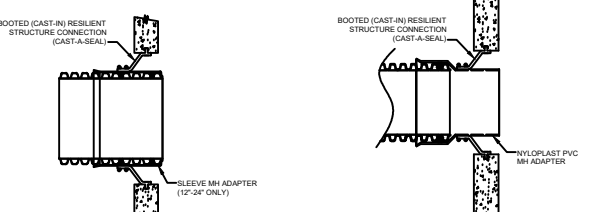

TABLE 1. SANITITE® HP SLEEVE MANHOLE ADAPTER

PIPE SIZE	ADS ADAPTER PRODUCT CODES		TRELLBORG PRESS SEAL SYSTEMS
	PKX DIRECT DRIVE	PKX DIRECT DRIVE	
12\"/>			

- NOTES:**
- PERFORMANCE HIGHLY DEPENDENT ON INSTALLATION. CONTRACTOR MUST ENSURE MANHOLE GASKET IS UNIFORMLY SEATED AROUND STRUCTURE ADAPTER. EXTRA PRECAUTIONS MUST BE TAKEN TO PREVENT DIFFERENTIAL SETTLEMENT BETWEEN THE PIPE AND MANHOLE.
 - SEE STANDARD DETAIL STD-201 AND TECHNICAL NOTE 5:04 CONNECTIONS TO MANHOLES AND STRUCTURES FOR INSTALLATION RECOMMENDATIONS.
 - NYLOPLAST PVC ADAPTER OD EQUIVALENT TO SDR 35

STD-205E

BOOTED (CORED OR CAST HOLE) RESILIENT STRUCTURE CONNECTION 30\"/>

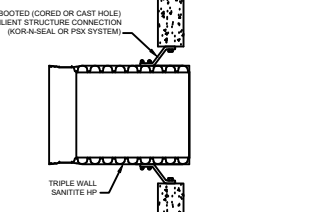

TABLE 1. SANITITE® HP SLEEVE MANHOLE ADAPTER

PIPE SIZE	ADS ADAPTER PRODUCT CODES		TRELLBORG PRESS SEAL SYSTEMS
	PKX DIRECT DRIVE	PKX DIRECT DRIVE	
30\"/>			

- NOTES:**
- PERFORMANCE HIGHLY DEPENDENT ON INSTALLATION. CONTRACTOR MUST ENSURE MANHOLE GASKET IS UNIFORMLY SEATED AROUND STRUCTURE ADAPTER. EXTRA PRECAUTIONS MUST BE TAKEN TO PREVENT DIFFERENTIAL SETTLEMENT BETWEEN THE PIPE AND MANHOLE.
 - SEE STANDARD DETAIL STD-201 AND TECHNICAL NOTE 5:04 CONNECTIONS TO MANHOLES AND STRUCTURES FOR INSTALLATION RECOMMENDATIONS.

STD-205F

POST INSTALLATION TESTING

DEFLECTION TESTING: WHEN TESTING FOR ALLOWABLE DEFLECTION LIMITS, THE MINIMUM SPECIFIED INSIDE DIAMETER SHOULD BE USED WHEN ESTABLISHING MANDREL SIZING. TABLE 1 LISTS THE INSIDE DIAMETERS THAT RESULT FROM 5% DEFLECTION BASED UPON THE MINIMUM INSIDE DIAMETER. MANDRELS MAY BE OBTAINED FROM A VARIETY OF COMMERCIAL SUPPLIERS.

LEAKAGE TESTING: SANITITE HP MAY BE TESTED IN ACCORDANCE WITH ASTM F1417 "STANDARD TEST METHOD FOR INSTALLATION ACCEPTANCE OF PLASTIC GRAVITY SEWER LINES USING LOW-PRESSURE AIR". TABLE 2 BELOW SUMMARIZES THE MINIMUM TIME THAT MUST BE REACHED FOR LESS THAN 0.5 OR 1.0 PSI OF PRESSURE DROP, DEPENDING ON THE DIAMETER AND LENGTH OF PIPE BEING TESTED, IN ACCORDANCE WITH ASTM F1417. WHEN THE PIPE IS LARGE ENOUGH TO BE PHYSICALLY ACCESSED, IT MAY BE DESIRABLE TO TEST INDIVIDUAL JOINTS FOR SAFETY REASONS. IN THESE CASES, CONSIDER JOINT TESTING IN ACCORDANCE WITH ASTM F3068.

TABLE 1. SANITITE® HP RECOMMENDED MANDREL SETTINGS

PIPE DIAM. WALL	PIPE DIAMETER	HOSE DIAMETER WITH 5% DEFLECTION	
		INSIDE	OUTSIDE
12\"/>			

TABLE 2. TIME FOR PRESSURE DROP FOR SANITITE HP (PER ASTM F1417)

PIPE DIAMETER (IN)	PRESSURE (PSI)	MINIMUM TEST TIME (MIN)	TIME FOR LENGTH SHOWN, (MIN SEC)							
			100 FT	150 FT	200 FT	250 FT	300 FT	350 FT	400 FT	450 FT
12\"/>										

- NOTES:**
- BASED UPON MINIMUM INSIDE DIAMETER PER ASTM F2736 & F2764.
 - DATA TAKEN FROM ASTM F1417 AND UNI-BELL UNI-B-6-98.

Drawn: ALI
 Date: 05/01/20
 Revision: 4
 Dwg No: STD-1300

SANITITE HP STANDARD DETAILS

