

**HP STORM DUAL WALL FABRICATED REDUCING TEES
30" X 12" - 36" X 24" DIAMETER (IB BELL\IB SPIGOT\BELL)**

PART #	PIPE SIZE	A	B	C	D	JOINT
3064AN65BP	30 x 12 in (750 x 300 mm)	41.1 in (1043 mm)	22.9 in (582 mm)	27.7 in (704 mm)	13.4 in (339 mm)	WT
3065AN65BP	30 x 15 in (750 x 375 mm)	45.0 in (1144 mm)	25.0 in (635 mm)	29.7 in (754 mm)	15.3 in (390 mm)	WT
3066AN65BP	30 x 18 in (750 x 450 mm)	49.0 in (1245 mm)	24.8 in (630 mm)	31.7 in (805 mm)	17.3 in (440 mm)	WT
3067AN65BP	30 x 24 in (750 x 600 mm)	53.0 in (1346 mm)	26.8 in (681 mm)	33.7 in (855 mm)	19.3 in (491 mm)	WT
3664AN65BP	36 x 12 in (900 x 300 mm)	36.5 in (928 mm)	24.3 in (617 mm)	23.2 in (589 mm)	13.4 in (339 mm)	WT
3665AN65BP	36 x 15 in (900 x 375 mm)	41.8 in (1061 mm)	25.8 in (655 mm)	25.8 in (656 mm)	16.0 in (406 mm)	WT
3666AN65BP	36 x 18 in (900 x 450 mm)	47.0 in (1195 mm)	25.5 in (648 mm)	28.4 in (722 mm)	18.6 in (472 mm)	WT
3667AN65BP	36 x 24 in (900 x 600 mm)	52.3 in (1328 mm)	27.0 in (686 mm)	31.1 in (789 mm)	21.2 in (539 mm)	WT

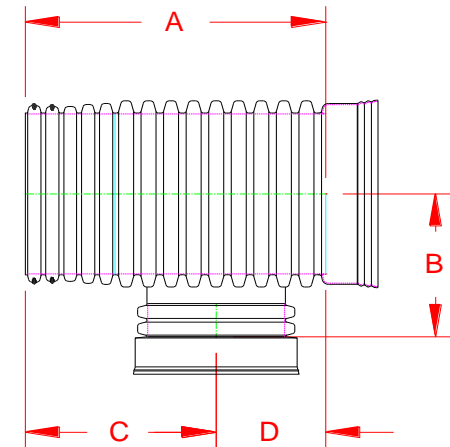

WT (INCLUDES 3 GASKETS)

NOTE: ALL FITTINGS DIMENSIONS ARE FOR REFERENCE ONLY

© 2021 Advanced Drainage Systems, Inc.

 Advanced Drainage Systems, Inc.	DRAWING #:	HP 11450
	DRAWN BY:	TJR 11/17/2009
	APPROVED BY:	
	REVISIONS:	TJR 5/13/2014