

**HP STORM DUAL WALL FABRICATED REDUCERS**  
**42" x 12" - 60" x 24" DIAMETER (IB BELLBELL)**

PART #	PIPE SIZE	A	B	C	JOINT
4274AN65BP	42 x 12 in (1050x 300 mm)	31.0 in (788 mm)	24.5 in (623 mm)	6.5 in (165 mm)	WT
4275AN65BP	42 x 15 in (1050 x 375 mm)	32.3 in (820 mm)	24.5 in (623 mm)	7.8 in (197 mm)	WT
4276AN65BP	42 x 18 in (1050 x 450mm)	33.4 in (849 mm)	24.5 in (623 mm)	8.9 in (226 mm)	WT
4277AN65BP	42 x 24 in (1050 x 600 mm)	31.5 in (801 mm)	24.5 in (623 mm)	7.0 in (178 mm)	WT
4874AN65BP	48 x 12 in (1200 x 300 mm)	31.7 in (806 mm)	25.2 in (641 mm)	6.5 in (165 mm)	WT
4875AN65BP	48 x 15 in (1200 x 375 mm)	33.0 in (838 mm)	25.2 in (641 mm)	7.8 in (197 mm)	WT
4876AN65BP	48 x 18 in (1200 x 450 mm)	34.1 in (867 mm)	25.2 in (641 mm)	8.9 in (226 mm)	WT
4877AN65BP	48 x 24 in (1200 x 600 mm)	32.2 in (819 mm)	25.2 in (641 mm)	7.0 in (178 mm)	WT
6074AN65BP	60 x 12 in (1500 x 300 mm)	36.5 in (928 mm)	30.0 in (763 mm)	6.5 in (165 mm)	WT
6075AN65BP	60 x 15 in (1500 x 375 mm)	37.8 in (960 mm)	30.0 in (763 mm)	7.8 in (197 mm)	WT
6076AN65BP	60 x 18 in (1500 x 450 mm)	38.9 in (988 mm)	30.0 in (763 mm)	8.4 in (213 mm)	WT
6077AN65BP	60 x 24 in (1500 x 600 mm)	37.0 in (941 mm)	30.0 in (763 mm)	7.0 in (178 mm)	WT

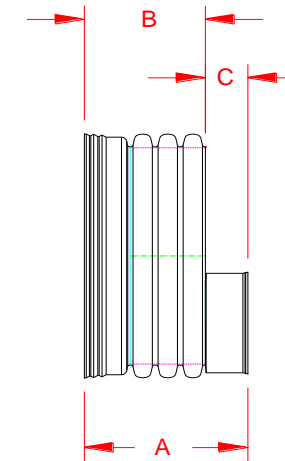

WT (INCLUDES 1 GASKETS)

NOTE: ALL FITTINGS DIMENSIONS ARE FOR REFERENCE ONLY

© 2021 Advanced Drainage Systems, Inc.

 Advanced Drainage Systems, Inc.	DRAWING #:	HP 12300	
	DRAWN BY:	TJR	11/17/2009
	APPROVED BY:		
	REVISIONS:	TJR	5/13/2014