

**HP STORM DUAL WALL FABRICATED 45° WYES
12" - 18" DIAMETER (BELL\BELL)**

PART #	PIPE SIZE	A	B	C	JOINT
1284AN65BP	12 in (300 mm)	27.4 in (696 mm)	21.6 in (549 mm)	21.6 in (549 mm)	WT
1585AN65BP	15 in (375 mm)	34.1 in (865 mm)	26.2 in (665 mm)	26.2 in (665 mm)	WT
1886AN65BP	18 in (450 mm)	37.0 in (940 mm)	29.1 in (738 mm)	29.1 in (738 mm)	WT

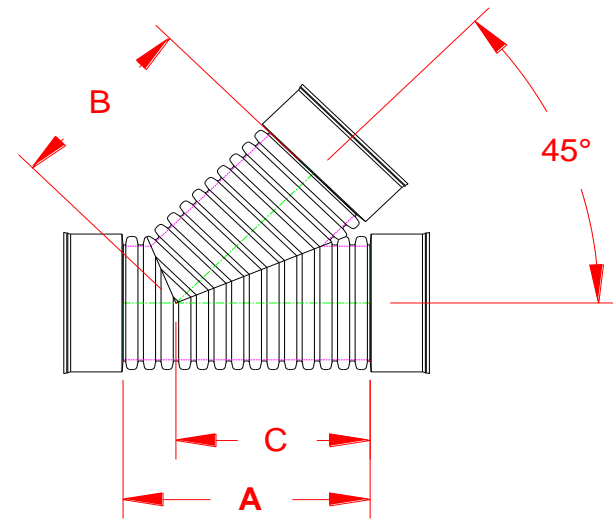

WT (INCLUDES 3 GASKETS)

NOTE: ALL FITTINGS DIMENSIONS ARE FOR REFERENCE ONLY

© 2021 Advanced Drainage Systems, Inc.



DRAWING #:	HP 10100	
DRAWN BY:	TJR	10/14/2009
APPROVED BY:		
REVISIONS:	TJR	3/24/2016