

## HP STORM DUAL WALL FABRICATED REDUCERS 42" x 12" - 60" x 24" DIAMETER (PLAIN END)

PART #	PIPE SIZE	A	B	C	JOINT
4274ANP	42 x 12 in (1050 x 300 mm)	25.2 in (641 mm)	15.4 in (392 mm)	9.8 in (249 mm)	ST
4275ANP	42 x 15 in (1050 x 375 mm)	25.9 in (658 mm)	15.4 in (392 mm)	10.5 in (266 mm)	ST
4276ANP	42 x 18 in (1050 x 450 mm)	26.0 in (660 mm)	15.4 in (392 mm)	10.6 in (268 mm)	ST
4277ANP	42 x 24 in (1050 x 600 mm)	27.9 in (710 mm)	15.4 in (392 mm)	12.5 in (318 mm)	ST
4874ANP	48 x 12 in (1200 x 300 mm)	25.5 in (648 mm)	15.7 in (399 mm)	9.8 in (249 mm)	ST
4875ANP	48 x 15 in (1200 x 375 mm)	26.2 in (665 mm)	15.7 in (399 mm)	10.5 in (266 mm)	ST
4876ANP	48 x 18 in (1200 x 450 mm)	26.3 in (667 mm)	15.7 in (399 mm)	10.6 in (268 mm)	ST
4877ANP	48 x 24 in (1200 x 600 mm)	28.2 in (717 mm)	15.7 in (399 mm)	12.5 in (318 mm)	ST
6074ANP	60 x 12 in (1500 x 300 mm)	27.8 in (706 mm)	18.0 in (457 mm)	9.8 in (249 mm)	ST
6075ANP	60 x 15 in (1500 x 375 mm)	28.5 in (723 mm)	18.0 in (457 mm)	10.5 in (266 mm)	ST
6076ANP	60 x 18 in (1500 x 450 mm)	28.6 in (726 mm)	18.0 in (457 mm)	10.6 in (268 mm)	ST
6077ANP	60 x 24 in (1500 x 600 mm)	30.5 in (775 mm)	18.0 in (457 mm)	12.5 in (318 mm)	ST

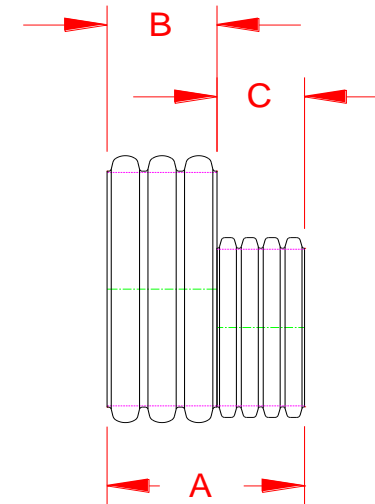

NOTE: ALL FITTINGS DIMENSIONS ARE FOR REFERENCE ONLY

© 2021 Advanced Drainage Systems, Inc.

 Advanced Drainage Systems, Inc.	DRAWING #:	HP 12100
	DRAWN BY:	TJR 10/19/2009
	APPROVED BY:	
	REVISIONS:	TJR 5/13/2014