

# StreamFilter<sup>®</sup> Catch Basin

## Media Filters

With over fifteen years in research and development, the BayFilter™ is the most efficient, effective, economical, and easy-to-use stormwater treatment filter cartridge on the market today. The StreamFilter Catch Basin utilizes a single or double BayFilter cartridge design to satisfy treatment flow requirements of up to 90 GPM (0.2 cfs) for a single location.

Utilizing steel catch basin structures, a proven mixed media filter, and a proprietary spiral wrapped layered construction; StreamFilter removes very fine sediment and nutrient pollutants. The vertically spiraled layered design maximizes flow rates and filter media area for the most effective stormwater treatment, while up-flow filtration allows for BayFilter's unique hydrodynamic backwash cleansing process. This process dislodges pollutants off the cartridge and onto the floor of the vault and restores the porosity of the mixed media filter. The draindown filter module assures there is no unwanted standing water in the catch basin between storm events. With its proven performance and cost effective design the StreamFilter system is the ideal solution for shallow sites and small to mid-sized drainage basins.

### Features

- Low drop filter cartridge system
- Peak flow bypass
- Grate, curb, and pipe inlet options
- Delivers fully assembled and installs like a standard catchbasin
- No confined space entry required for maintenance

### StreamFilter Design Summary

StreamFilter Steel Catch Basin Size	Number of Cartridges	BF522 Cartridge	BF545 Cartridge	Approximate Pick Weight (lbs)
		2.33' Drop Required Treatment Capacity	3.58' Drop Required Treatment Capacity	
3' x 5'	1	22.5 gpm / 0.05 cfs	45 gpm / 0.10 cfs	2,000
3' x 8'	2	45 gpm / 0.10 cfs	90 gpm / 0.20 cfs	3,500

1. Drop Required value = Rim Elevation - Outlet IE.
2. All configurations can internally bypass up to 2.0 cfs.

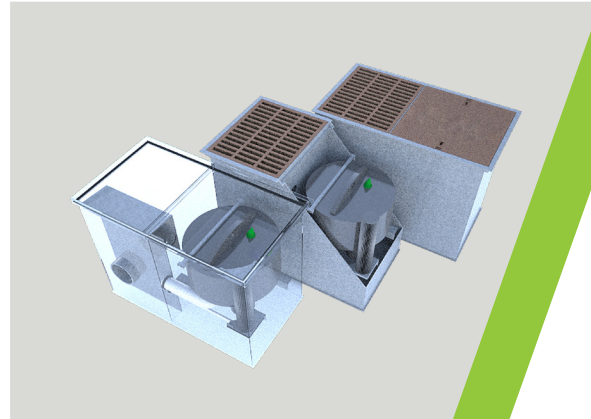

# StreamFilter Stormwater Filtration System Specifications

## Products

- **Internal Components:** All components including steel structure(s), PVC manifold piping and filter cartridges, shall be provided by BaySaver Technologies LLC, 1030 Deer Hollow Drive, Mount Airy, MD (800.229.7283)
- **PVC Manifold Piping:** All internal PVC pipe and fittings shall meet ASTM D1785. Manifold piping shall be provided to the contractor precut and pre-assembled.
- **Filter Cartridges:** External shell of the filter cartridges shall be substantially constructed of polyethylene or equivalent material acceptable to the manufacturer. Filtration media shall be arranged in a spiral layered fashion to maximize available filtration area. An orifice plate shall be supplied with each cartridge to restrict the flow rate to a maximum of 45 GPM.
- **Filter Media:** Filter media shall be by BaySaver Technologies LLC and shall consist of the following mix: a blend of Zeolite, Perlite and Activated Alumina.
- **Steel Catch Basin:** Steel catch basin structures shall have a minimum ¼" wall thickness and painted or coated to protect from corrosion. Basin construction, dimensions, coatings, grates and covers shall comply with local building and plumbing codes. Steel Catch Basin structures shall be provided by BaySaver Technologies, LLC.

## Performance

- The stormwater filter system is capable of treating 100% of the required treatment flow at full sediment load conditions. The stormwater filter systems shall have no moving parts.
- The stormwater treatment unit shall be designed to remove at least 80% of total suspended solids, 50% of total copper and 45% of total zinc based on field data collected in compliance with the Technology Acceptance Reciprocity Partnership Tier II test protocol.
- The stormwater filtration system shall reduce incoming turbidity (measured as NTUs) by 65% or more and shall not have any components that leach nitrates or phosphates.
- The stormwater filtration cartridge shall be equipped with a hydrodynamic backwash mechanism to extend the filter's life and optimize its performance.
- The stormwater filtration system shall be designed to remove a minimum of 65% of the incoming Total Phosphorus (TP) load.
- The stormwater filtration system's cartridge units shall have a treated sediment capacity for 80% TSS removal of 175 lbs.

## Installation

Installation of the StreamFilter System(s) shall be performed per manufacturer's Installation Instructions.

For more information on StreamFilter Stormwater Filtration System and other products, please contact our Customer Service representatives at 1-800-229-7283

