

HP STORM DUAL WALL FABRICATED REDUCERS 15" x 12" - 36" x 24" DIAMETER (PLAIN END)

PART #	PIPE SIZE	A	B	C	JOINT
1574ANP	15 x 12 in (375x 300 mm)	17.7 in (449 mm)	7.9 in (200 mm)	9.8 in (249 mm)	ST
1874ANP	18 x 12 in (450 x 300 mm)	17.7 in (450 mm)	7.9 in (201 mm)	9.8 in (249 mm)	ST
1875ANP	18 x 15 in (450 x 375mm)	18.4 in (468 mm)	7.9 in (201 mm)	10.5 in (266 mm)	ST
2474ANP	24 x 12 in (600 x 300 mm)	19.3 in (491 mm)	9.5 in (242 mm)	9.8 in (249 mm)	ST
2475ANP	24 x 15 in (600 x 375 mm)	20.0 in (509 mm)	9.5 in (242 mm)	10.5 in (266 mm)	ST
2476ANP	24 x 18 in (600 x 450 mm)	20.1 in (511 mm)	9.5 in (242 mm)	10.6 in (268 mm)	ST
3074ANP	30 x 12 in (750 x 300 mm)	21.7 in (552 mm)	11.9 in (303 mm)	9.8 in (249 mm)	ST
3075ANP	30 x 15 in (750 x 375 mm)	22.4 in (569 mm)	11.9 in (303 mm)	10.5 in (266 mm)	ST
3076ANP	30 x 18 in (750 x 450 mm)	22.5 in (572 mm)	11.9 in (303 mm)	10.6 in (268 mm)	ST
3077ANP	30 x 24 in (750 x 600 mm)	24.5 in (621 mm)	11.9 in (303 mm)	12.5 in (318 mm)	ST
3674ANP	36 x 12 in (900 x 300 mm)	25.5 in (649 mm)	15.7 in (400 mm)	9.8 in (249 mm)	ST
3675ANP	36 x 15 in (900 x 375 mm)	26.2 in (666 mm)	15.7 in (400 mm)	10.5 in (266 mm)	ST
3676ANP	36 x 18 in (900 x 450 mm)	26.3 in (668 mm)	15.7 in (400 mm)	10.6 in (268 mm)	ST
3677ANP	36 x 24 in (900 x 600 mm)	28.3 in (718 mm)	15.7 in (400 mm)	15.5 in (394 mm)	ST

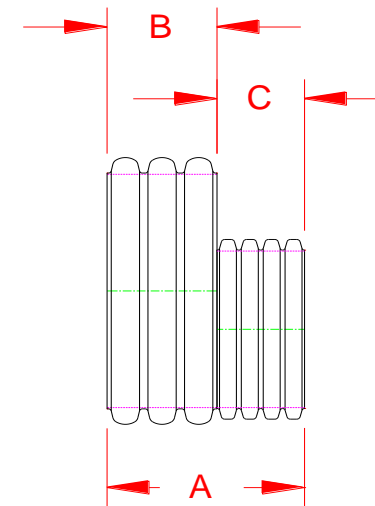

NOTE: ALL FITTINGS DIMENSIONS ARE FOR REFERENCE ONLY

© 2021 Advanced Drainage Systems, Inc.



DRAWING #:	HP 12000
DRAWN BY:	TJR 10/19/2009
APPROVED BY:	
REVISIONS:	TJR 5/13/2014