

BOOTED (CAST-IN) RESILIENT STRUCTURE CONNECTION

12"- 30" HDPE N-12

W/ NYLOPLAST PVC MH ADAPTER

PIPE SIZE	NYLOPLAST PVC ADAPTER	PRESS SEAL® SYSTEMS *
		CAST-A-SEAL
12" (300mm)	1277AGU	CAS 603 OR 802
15" (375mm)	1577AGU	CAS 603 OR 802
18" (450mm)	1877AGU	CAS 802
24" (600mm)	2477AGU	CAS 802
30" (750mm)	3077AGU	CAS 802

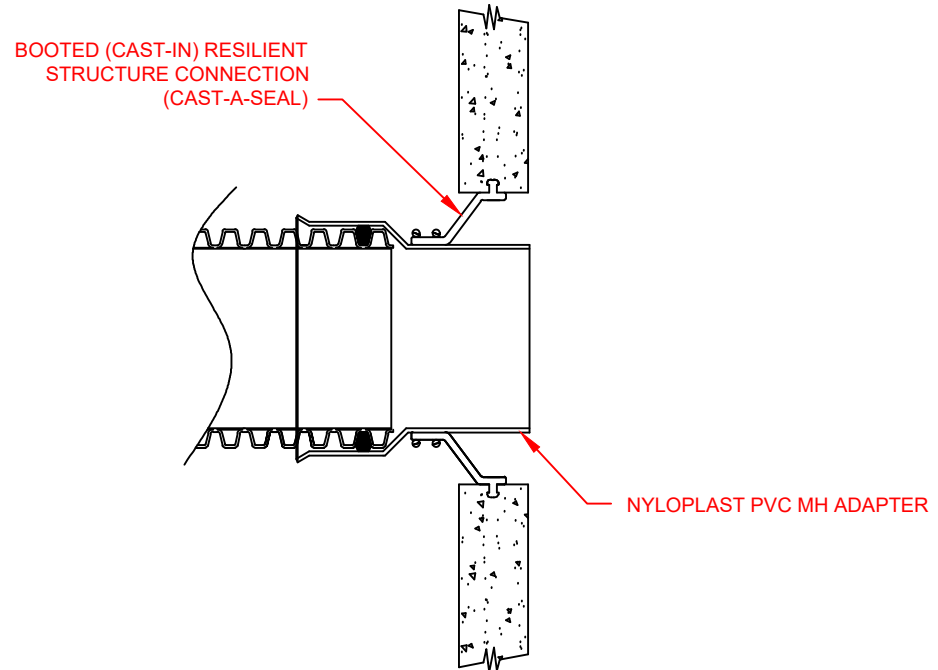

NOTES:
 PERFORMANCE HIGHLY DEPENDENT ON INSTALLATION. CONTRACTOR MUST ENSURE MANHOLE GASKET IS UNIFORMLY SEATED AROUND STRUCTURE ADAPTER. EXTRA PRECAUTIONS MUST BE TAKEN TO PREVENT DIFFERENTIAL SETTLEMENT BETWEEN THE PIPE AND MANHOLE.

SEE STANDARD DETAIL STD-201 AND TECHNICAL NOTE: 5.04 HDPE CONNECTIONS TO MANHOLES AND STRUCTURES FOR INSTALLATION RECOMMENDATIONS.

NYLOPLAST PVC ADAPTER OD EQUIVALENT TO SDR 35

REV.	DESCRIPTION	BY	MM/DD/YY	CHK'D
6	UPDATED DETAIL AND TABLE	AMT	09-09-19	

* THIRD PARTY - CODES AS SUPPLIED BY MANUFACTURER
 CAST-A-SEAL is a registered trademark of PRESS-SEAL GASKET CORPORATION. (www.press-seal.com)

© 2019 ADS, INC.

ADVANCED DRAINAGE SYSTEMS, INC. ("ADS") HAS PREPARED THIS DETAIL BASED ON INFORMATION PROVIDED TO ADS. THIS DRAWING IS INTENDED TO DEPICT THE COMPONENTS AS REQUESTED. ADS HAS NOT PERFORMED ANY ENGINEERING OR DESIGN SERVICES FOR THIS PROJECT, NOR HAS ADS INDEPENDENTLY VERIFIED THE INFORMATION SUPPLIED. THE INSTALLATION DETAILS PROVIDED HEREIN ARE GENERAL RECOMMENDATIONS AND ARE NOT SPECIFIC FOR THIS PROJECT. THE DESIGN ENGINEER SHALL REVIEW THESE DETAILS PRIOR TO CONSTRUCTION. IT IS THE DESIGN ENGINEER'S RESPONSIBILITY TO ENSURE THE DETAILS PROVIDED HEREIN MEETS OR EXCEEDS THE APPLICABLE NATIONAL, STATE, OR LOCAL REQUIREMENTS AND TO ENSURE THAT THE DETAILS PROVIDED HEREIN ARE ACCEPTABLE FOR THIS PROJECT.

12"-30" HDPE N-12 BOOTED (CAST-IN) STRUCTURE CONNECTION WITH PVC ADAPTER	
DRAWING NUMBER:	STD-204H



4640 TRUEMAN BLVD
 HILLIARD, OHIO 43026

DRAWN BY:	CKS
DATE:	10/10/06
CHK'D BY:	
SCALE:	NTS
SHEET:	1 OF 1